

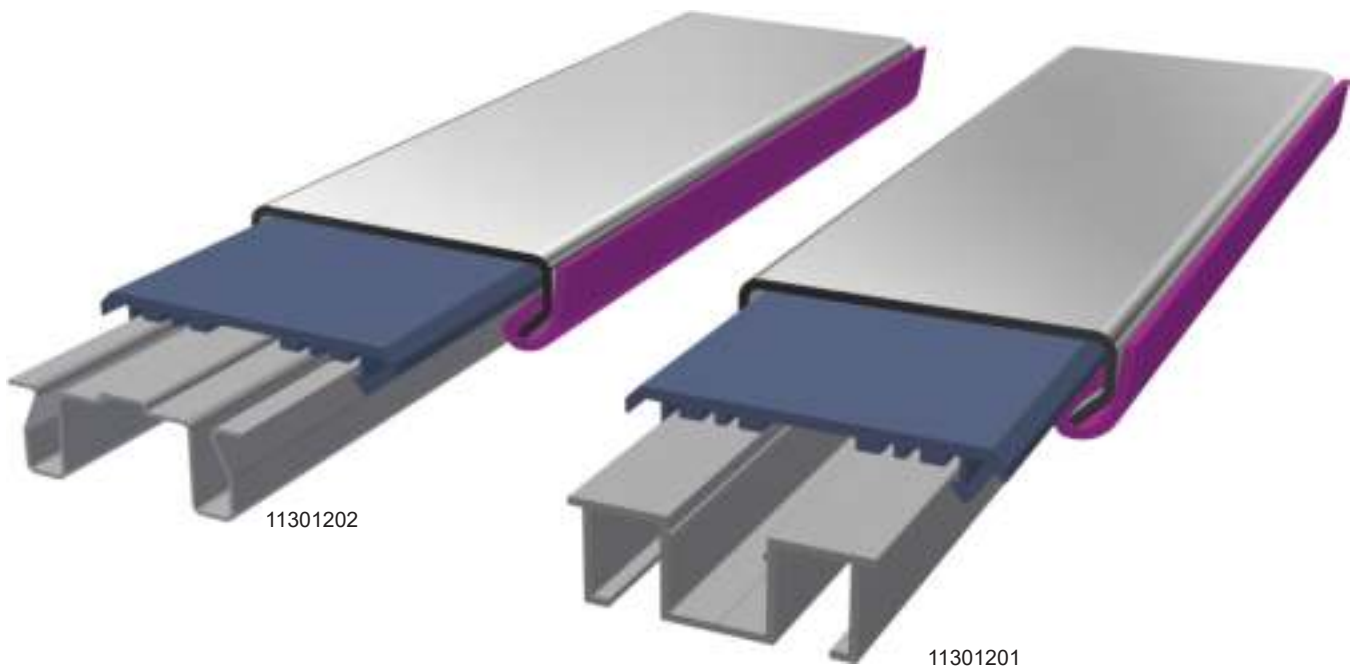

J-MAX™ FLOORING

KEITH Manufacturing Co.
www.KeithWalkingFloor.com
World Headquarters
Toll-Free: 800-547-6161
Phone: +1-541-475-3802



PARTS CATALOG

Original Instructions

©2022 KEITH Manufacturing Co. All Rights Reserved. KEITH, KEITH logo and WALKING FLOOR are registered trademarks of KEITH Manufacturing Co. Equipment manufactured by KEITH Manufacturing Co. is protected by numerous patents both domestic and foreign.

Released: 2022-10-19

DOC06874 Rev. E

Table of Contents

Contact Information - KEITH Manufacturing Co.	i
Service Information	1
Special Tool	1
Pre-Order Information Required	2
1.1 Dimensions 'A' & 'B' Measured from Trailer	2
1.2 Determine Quantity of Floor Slats	3
J-Max Flooring 4-5/16 inch [109.5 mm] Slat Centers	3
J-Max Floor Slat Assembly Details	4
J-Max Floor Slat Assemblies	5
J-Max Flooring Components	7
J-Max Sub-Deck Alignment Jigs	7
Bolt Torque Chart	7

Contact Information - KEITH Manufacturing Co.

World Headquarters - USA

401 NW Adler St.
P.O. Box 1
Madras, OR 97741
Toll-Free: 800-547-6161
Phone: +1-541-475-3802
Email: Sales@KeithWalkingFloor.com
Email: TechDept@KeithWalkingFloor.com

KEITH WALKING FLOOR India Private Limited

Paragon 4B - 26
Phoenix Marketcity
LBS Marg, Kurla, Mumbai, Maharashtra 400070
Tel: +91-44-48526805
Email: Solutions@KeithWalkingFloor.in

Canada

Brantford, ON
Phone: +1-519-756-9178
Email: CanadaSales@KeithWalkingFloor.com

México

Guadalajara, Jal.
Phone: +52-333-616-5079
Email: KMC_Mexico@KeithWalkingFloor.com

Australia

Waverley Gardens, VIC
Phone: +61-3-9562-2190
Email: AUSales@KeithWalkingFloor.com

Europe

Barneveld, The Netherlands
Phone: +31-342-422007
Email: EuroSales@KeithWalkingFloor.com

***Not all parts or services available in all regions.
Contact your regional office for information on available parts and services.***

Service Information



NOTE: When welding, ground specifically to what you are welding on, otherwise it can short across component assemblies damaging seals and gaskets.

KEITH Mfg. fabricates many standard drive systems and also fabricates custom drive systems, too numerous to include, therefore KEITH requires the following information from your drive system to ensure we provide you with most accurate information. Please have the following information readily available before contacting KEITH for support:

- Model Number (Located on the Serial Plate of the drive unit)
- Serial Number (Located on the Serial Plate on the drive unit)
- Quantity & length of floor slats
- Vehicle make and unit installer

Special Tool

J-Seal Seating Tool #10798101.



Dimensions for drives with an 8 inch [203 mm] stroke length

Dimensions for drives with an 10 inch [254 mm] stroke length

Pre-Order Information Required

1.1 Dimensions 'A' & 'B' Measured from Trailer

'A' = Measured inside length of trailer from inside front bulkhead wall to inside rear door

'B' = Measured distance from forward most crossmember at rear of drive opening to inside rear door

(See Figure 3)

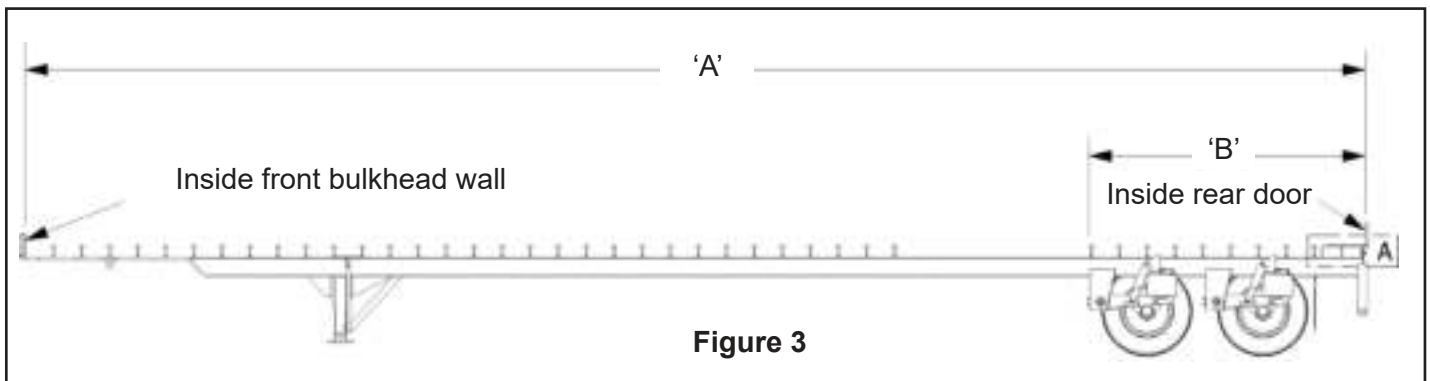

Reference drawing # 11378501 for component dimensioning with RFI drive.

1.2 Determine Quantity of Floor Slats

1. Use the formula below to determine the quantity of floor slats needed and the width of the side seals required. (See Figure 4)

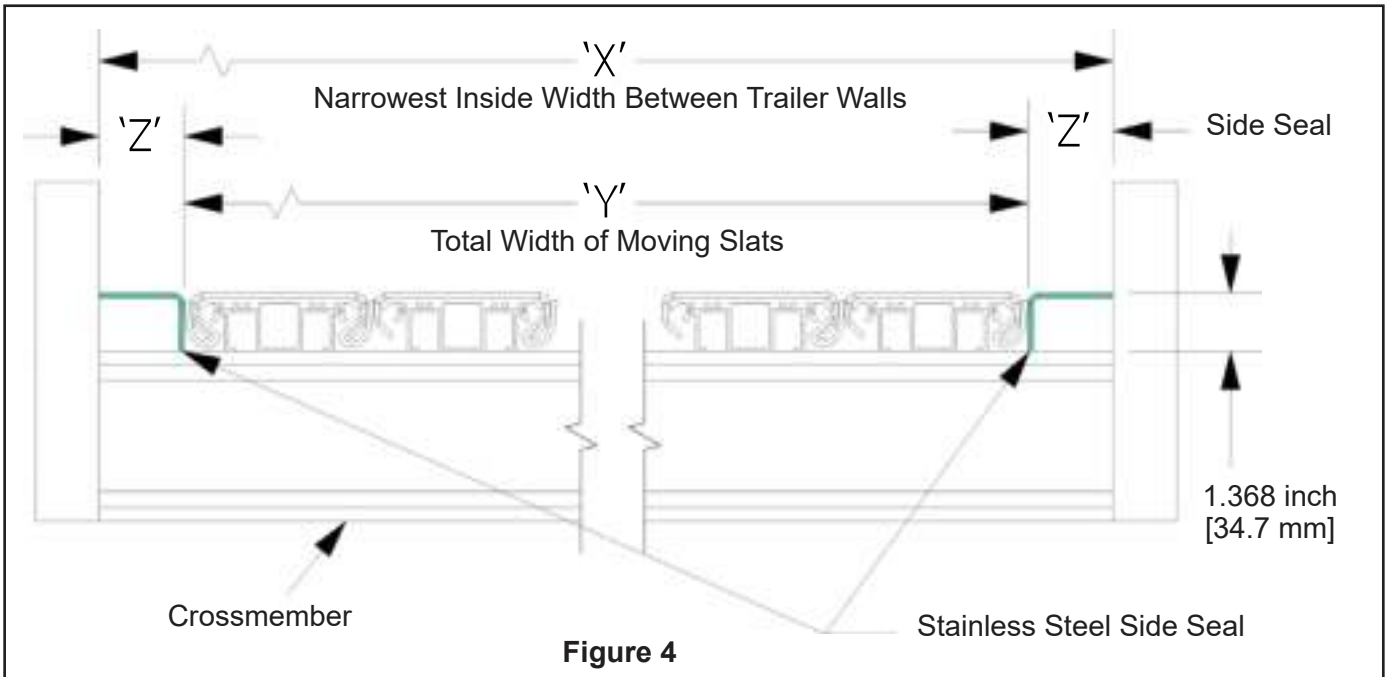

$$('X' - 'Y') / 2 = 'Z'$$

J-Max Flooring 4-5/16 inch [109.5 mm] Slat Centers

X = Distance Across Trailer	N = Number of Moving Slats	Y = (N * 4.3125 inch) + .175 inch	Z*2 = Combined Width of Side Seals
	15	64.86 inch [1647.5 mm]	
	16	69.18 inch [1757.0 mm]	
	17	73.49 inch [1866.6 mm]	
	18	77.80 inch [1976.1 mm]	
	19	82.11 inch [2085.7 mm]	
	20	86.43 inch [2195.2 mm]	
	standard 21	90.74 inch [2304.7 mm]	
	22	95.05 inch [2414.3 mm]	
Examples	21	90.74 inches	6 inches
	21	2304.7 mm	134 mm

Z=3 inches
Z=67 mm

J-Max Floor Slat Assembly Details

J-MAX slat assembly as supplied by KEITH Manufacturing Co.

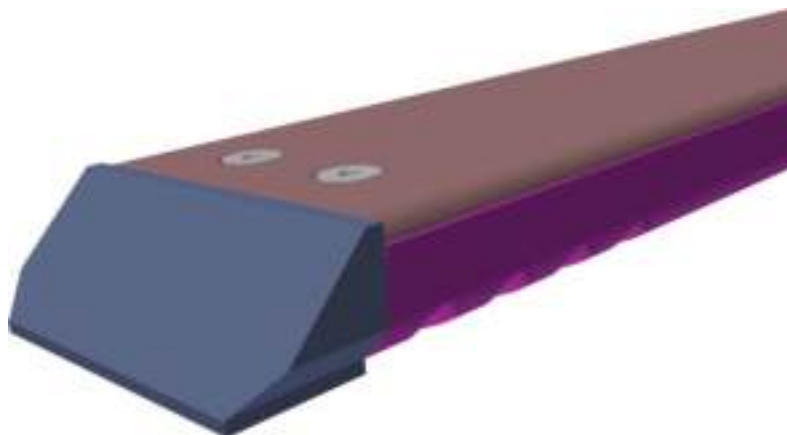
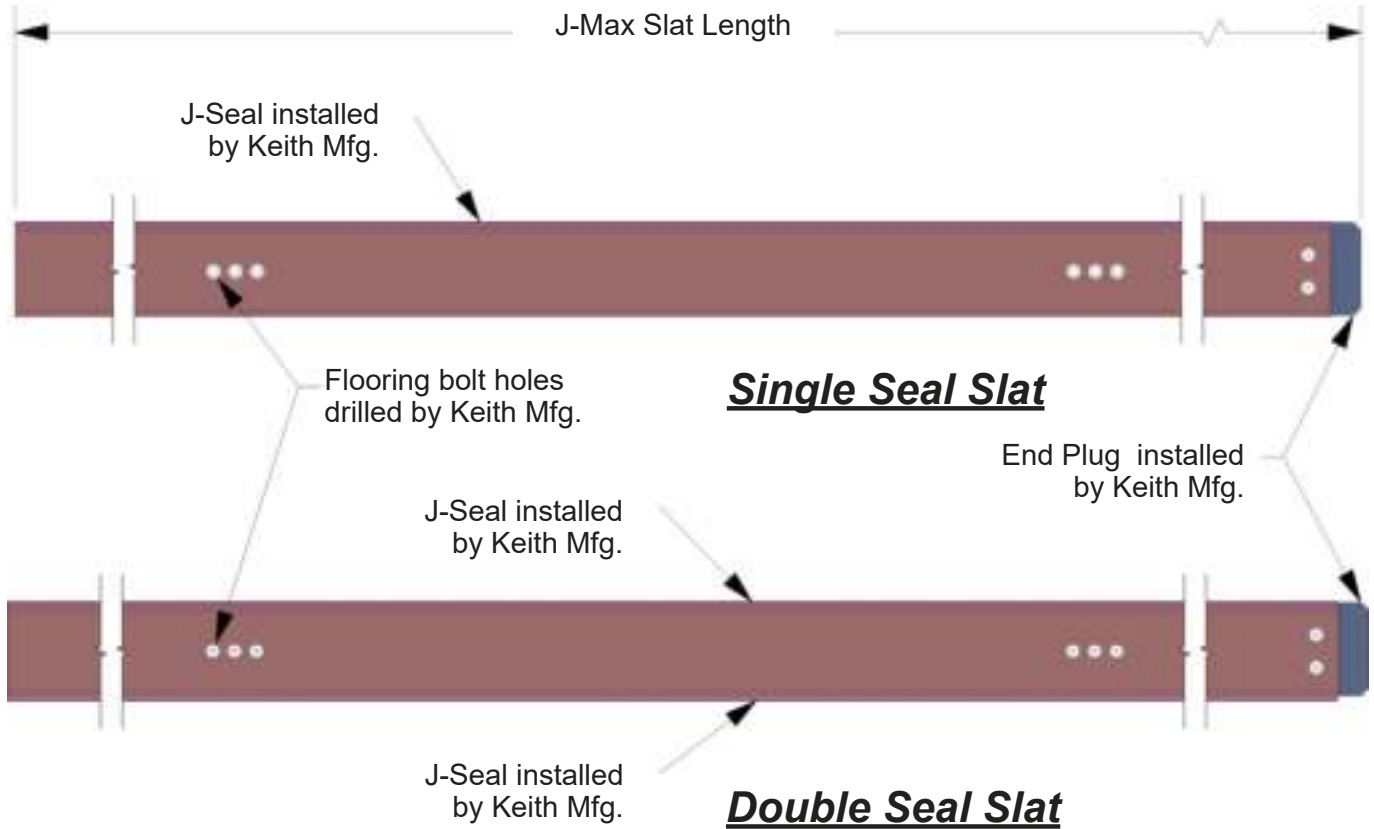

As Shipped: Assembled with J-Seal & End Plug

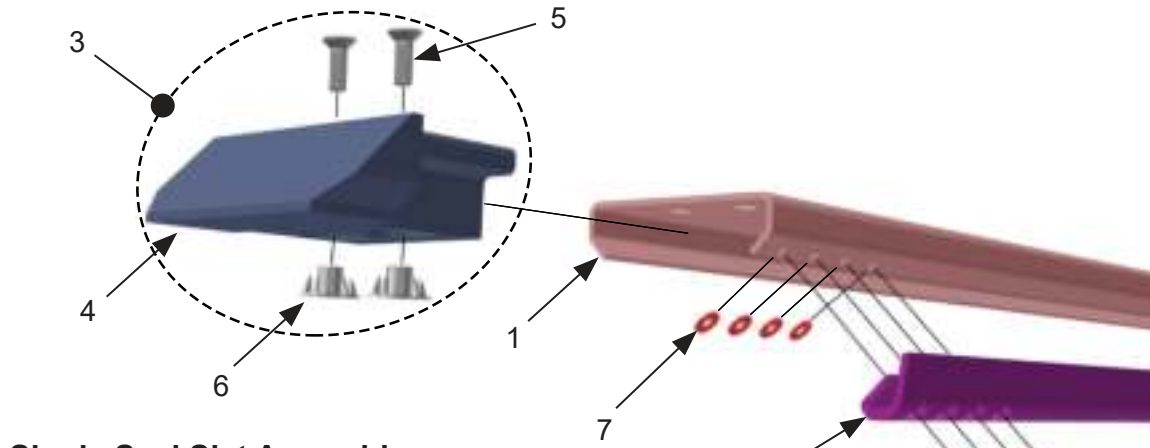

Single Seal Slat Assembly

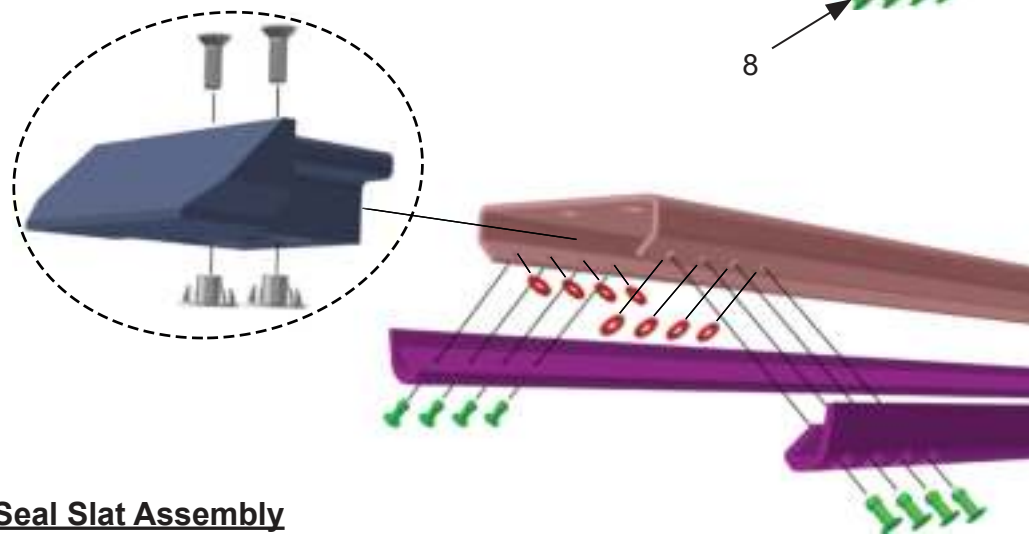

Double Seal Slat Assembly

J-Max Floor Slat Assemblies

ID#	Qty	Single Seal Slat Part #	Double Seal Slat Part #	DESCRIPTION
1	1	2921	2921	Floor Slat - 3 mm High Strength Steel (standard)
	1	2984	2984	Floor Slat - 3 mm Stainless Steel
2	(1)	2914	(2) 2914	J-Seal (Standard)
	(1)	2972	(2) 2972	J-Seal - High Temp
3	-	10693604	10693604	End Plug Assembly - (Standard) (includes items 4-6)
	-	10693607	10693607	End Plug Assembly - High Temp (includes items 4-6)
4	1	10693603	10693603	End Plug (Standard)
	1	10693606	10693606	End Plug - High Temp
5	2	87701590	87701590	Bolts 8mm-1.25x25mm Zinc
6	2	86627505	86627505	T-Nuts M8x9.5x22mm
7	(4)	86550550	(8) 86550550	Flat Washer #10 Zinc (.5 inch OD .046 inch thick)
8	(4)	86525573	(8) 86525573	Rivet SS Blind Flush Head 3/16 inch x (.125 inch - .331 inch) Grip

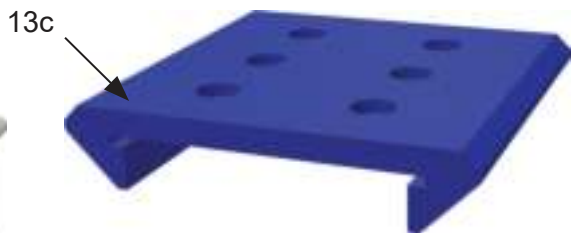
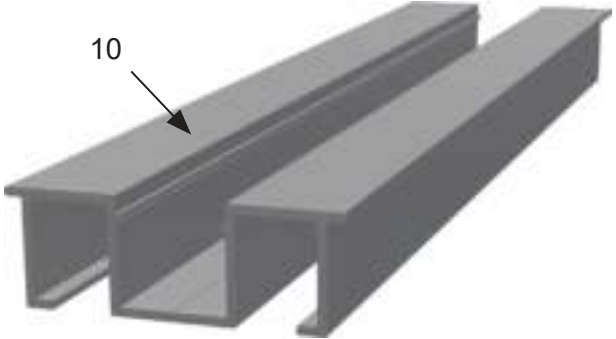
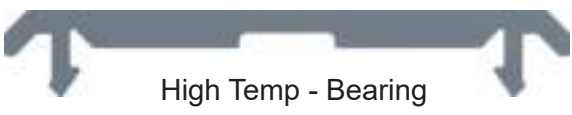
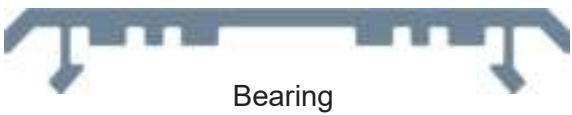
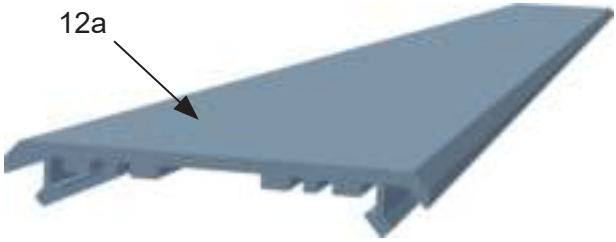

Drill Holes
Ø 5.1 mm
[.194 inch]

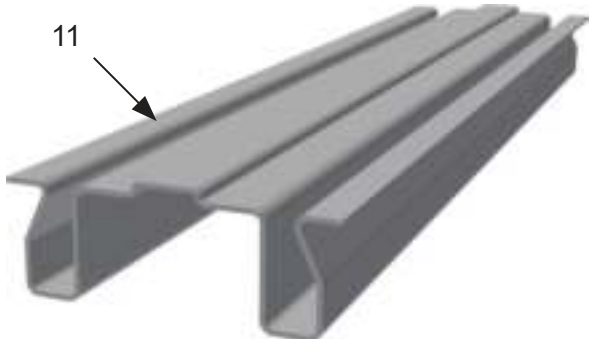

J-Max Flooring Components

ID#	Qty	SAE Part #	Metric Part #	DESCRIPTION
8	24 / slat	86525573	-	Rivet SS Blind Flush Head 3/16 inch x (.125 inch - .331 inch) Grip
10	varies	2929		Aluminum Sub-Deck
11	varies	2955		Steel Sub-Deck (Not available in all regions)
12a	varies	2944		Bearing (Standard)
12b	varies	2971		Bearing - High Temp
13a	4 / slat	11113916		Bearing Stop - UHMW
	4 / slat	11113918		Bearing Stop - High Temp
13b	4 / slat	11467601		Hold Down Bearing Stop - Single Seal (Standard)
	4 / slat	11467604		Hold Down Bearing Stop High Temp - Single Seal
13c	4 / slat	11467602		Hold Down Bearing Stop - Double Seal (Standard)
	4 / slat	11467605		Hold Down Bearing Stop High Temp - Double Seal
14	6-8 / slat	87402000	87701590	Floor Bolts 5/16-18 inch x 1 inch [8 mm-1.25 x 25 mm] Zinc
	6-8 / slat	87408100	87008480	Floor Bolts 3/8-16 inch x 1 inch [10 mm-1.5 x 25 mm] Zinc
15	6-8 / slat	86627500	87101000	Hex Nut Nylock 5/16-18 [M8x1.25] Zinc
	6-8 / slat	86628000	87102000	Hex Nut Nylock 3/8-16 [M10x1.5] Zinc

J-Max Sub-Deck Alignment Jigs

# of Slats	Part #	DESCRIPTION
15	10701515	Sub-Deck JIG FOR J-MAX Flooring #2929 15 SLAT 4.313 SC
16	10701516	Sub-Deck JIG FOR J-MAX Flooring #2929 16 SLAT 4.313 SC
17	10701517	Sub-Deck JIG FOR J-MAX Flooring #2929 17 SLAT 4.313 SC
18	10701518	Sub-Deck JIG FOR J-MAX Flooring #2929 18 SLAT 4.313 SC
19	10701519	Sub-Deck JIG FOR J-MAX Flooring #2929 19 SLAT 4.313 SC
20	10701520	Sub-Deck JIG FOR J-MAX Flooring #2929 20 SLAT 4.313 SC
21	10701521	Sub-Deck JIG FOR J-MAX Flooring #2929 21 SLAT 4.313 SC
22	10701522	Sub-Deck JIG FOR J-MAX Flooring #2929 22 SLAT 4.313 SC

Bolt Torque Chart

Bolt (SAE)	Grade	Torque (ft/lbs)	Location	Bolt (Metric)	Grade	Torque (Nm)
-	-	-	End Plugs	M8 x 1.25	10.9	34
5/16-18	8	24	Floor Bolts	M8 x 1.25	10.9	34
3/8-16	8	45	Floor Bolts	M10 x 1.5	10.9	66